

Instructions for 2 Trimmer Rack, 2TR

Assembly

TOOLS REQUIRED: Two 9/16" or equivalent wrenches.

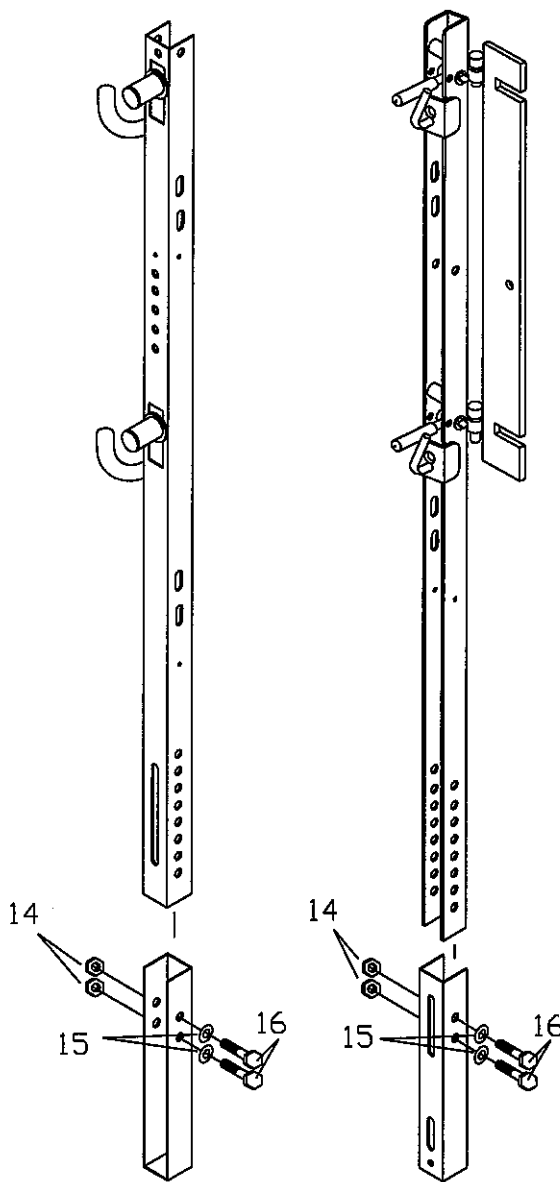

Attach the lower mounting brackets to the Trimmer Rack poles as shown in the figure above. Make sure the channels of the mounting bracket and the trimmer pole are opening in opposite directions as shown. Adjust the height of the Trimmer Rack to meet your needs. The height can also be adjusted after mounting on the trailer. From the included hardware, use two 2.5" x $\frac{3}{8}$ " bolts, two washers, and two serrated nuts per pole as shown above. Do not tighten the bolts yet.

Installation

TOOLS REQUIRED: Drill with 3/8" chuck, 3/8" drill bit, two 9/16" or equivalent wrenches.

1. Poles can be positioned on the trailer to suit your space needs or requirements, however the bottom figure shows a suggested mounting detail on the passenger side of the trailer. (Please note, the locking pole **MUST** be installed to the right of the compression pole). Once a suitable location is found, drill two 3/8" holes 38 3/4" apart through the top trailer rail and two more holes through the bottom rail directly below the holes in the top rail.

NOTE: To ensure proper mounting of Jungle Jim's TOOL RACK (Sold Separately), poles should be positioned 38 3/4" apart (center to center).

2. Secure the poles to the trailer with the mounting bolts, washers and nuts provided as illustrated below. Check that the trimmer rack height is correct before tightening the hardware. Re-adjust the height if necessary, then tighten all the hardware securely.

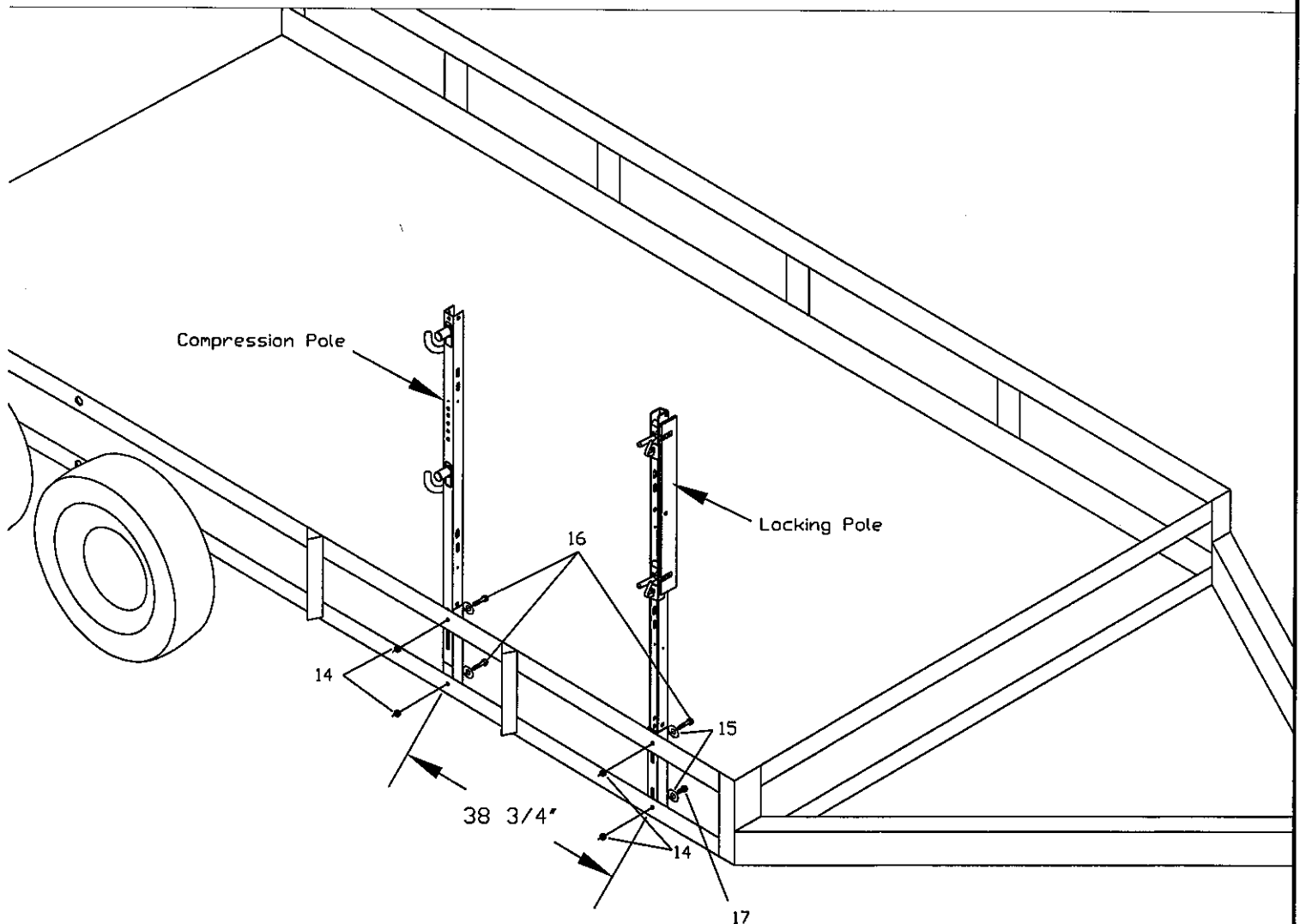

Locking

Your Trimmer Rack is designed so that all three trimmers can be locked on the pole using only one padlock (not included). Please be sure that your padlock has a 2" clearance as shown below and has at least a 1½" base. The padlock must be tight on the pole for the locking bar to secure the trimmers properly.

To lock your Trimmer Rack close the lock bar and insert the padlock through the locking holes in the pole and on the lock bar. The padlock should go all the way through both sides of the pole and the lock bar. Try to open the lock bar to ensure that the padlock works properly.

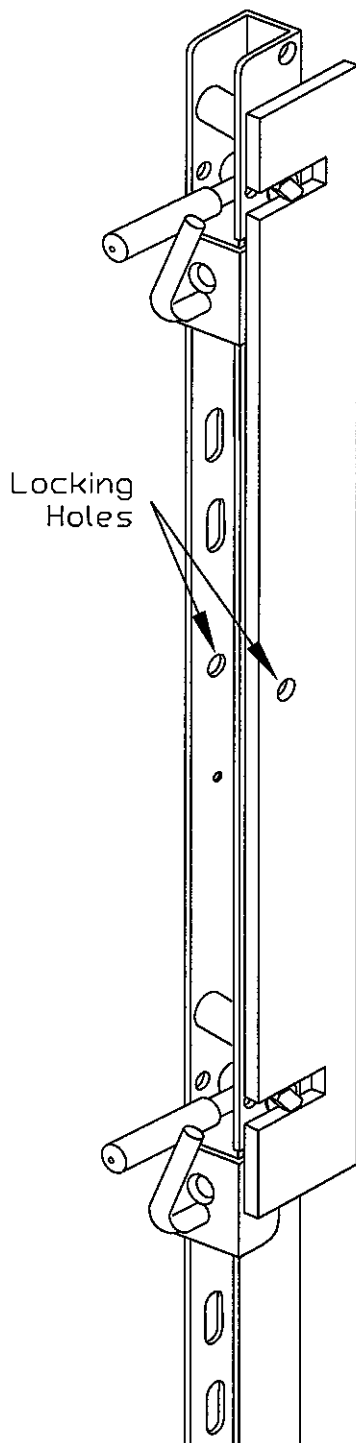

*Note: Use a lock that has a 2" clearance and at least a 1 1/2" base.

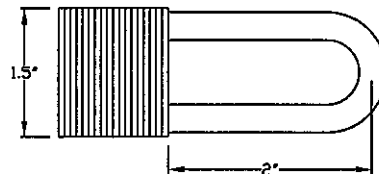

Parts

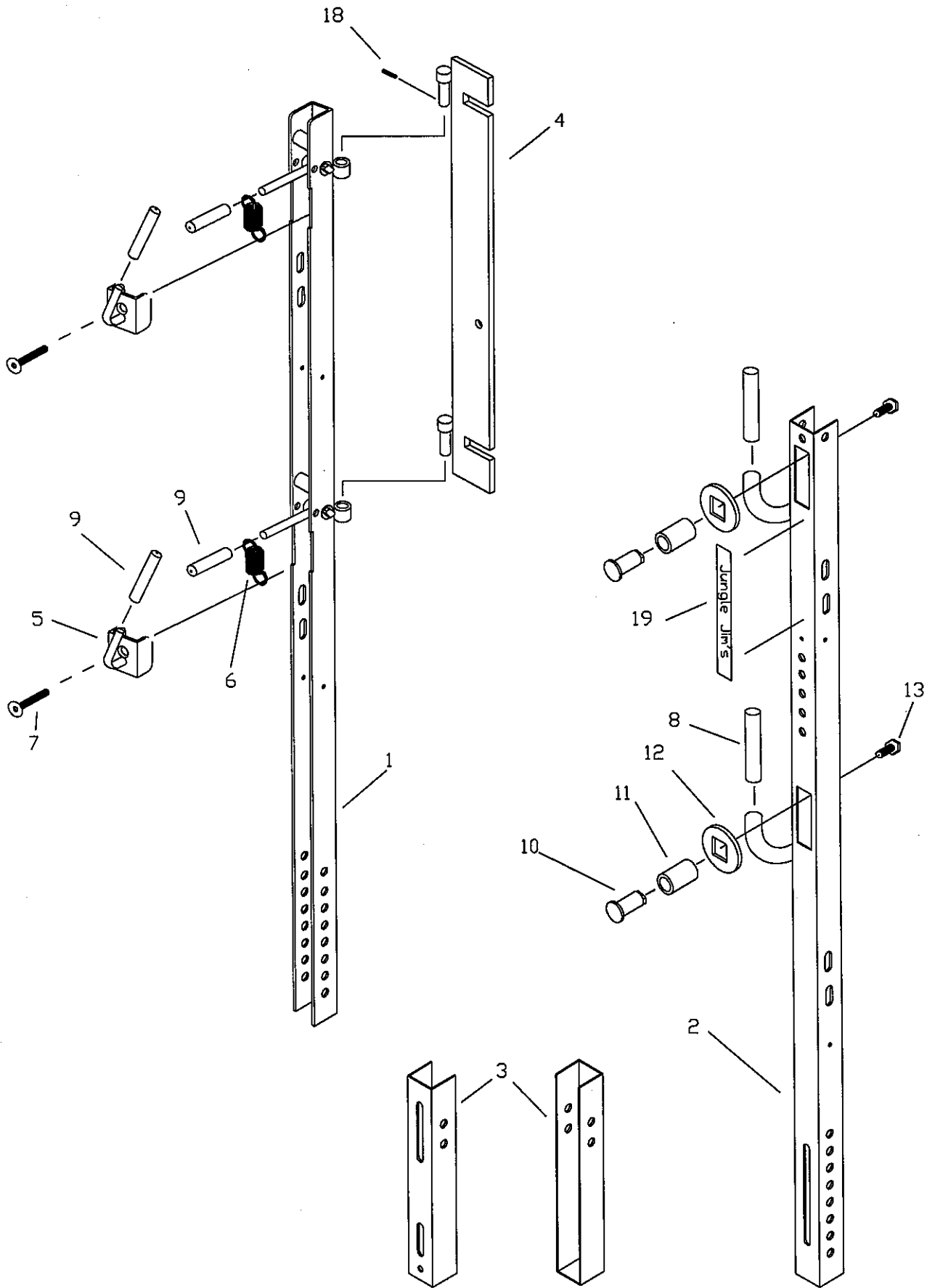

Parts List

#	PART #	DESCRIPTION	QTY
1	2TR-LP	2 Trimmer Rack, Locking Pole	1
2	2TR-CP	2 Trimmer Rack, Compression Pole	1
3	ATR-MB	Mounting Bracket	2
4	2TR-LBW	2 Trimmer Rack, Locking Bar Weldment	1
5	ATR-TH	Trimmer Hook	2
6	TRM-9	Extension Spring	2
7	TRM-1	3/8"-16 x 2" Flat Head Socket Screw	2
8	TM-VINYL	1/2" I.D. x 4 1/2" I.L. Vinyl	2
9	ATR-5	1/2" I.D. x 3 3/4" I.L. Vinyl	4
10	ATR-CP	Compression Pin	2
11	ATR-H	1/2" x 1" Hose	2
12	ATR-WASH	3/8" Square Washer	2
13	ATR-1	5/16"-18 x 5/8" Serrated Flange Bolt	2
14	JW9	3/8"-16 Hex Flange Nut	8
15	TRM-11	3/8" USS Flat Washer	8
16	ATR-2	3/8"-16 x 2 1/2" Hex Cap Screw	7
17	ATR-3	3/8"-16 x 1" Hex Cap Screw	1
18	GC--EXPAN2	5/32" x 7/8" Expan Pin	1
19	DECAL	Jungle Jim's Decal	1

Replacement Parts

TOOLS REQUIRED: 5mm Allen wrench

Replacement parts are available for your trimmer rack, should you ever need to replace anything. Below are instructions for replacing the trimmer hooks on your rack.

1. Remove the hook by unscrewing the $\frac{3}{8}$ "-16 x 2" flat head socket screw. If you are replacing the spring, you will need to carefully cut off the $3\frac{3}{4}$ " vinyl on the locking arm and slide the spring off.
2. Place a new spring on the locking arm. Be sure that the eye-holes on the ends of the spring are oriented as shown in the figure below. Slide the spring onto the locking arm so, that the eye-hole sits in the notch on the locking arm. After the spring is installed, slide a new $3\frac{3}{4}$ " vinyl onto the locking arm.
3. Place the trimmer hook on the pole. Insert the $\frac{3}{8}$ "-16 x 2" flat head socket screw through the trimmer hook, through the bottom eye-hole on the spring, and into the threaded insert on the pole. Be sure the bolt goes through the hole in the spring and tighten securely with a 5mm Allen wrench.

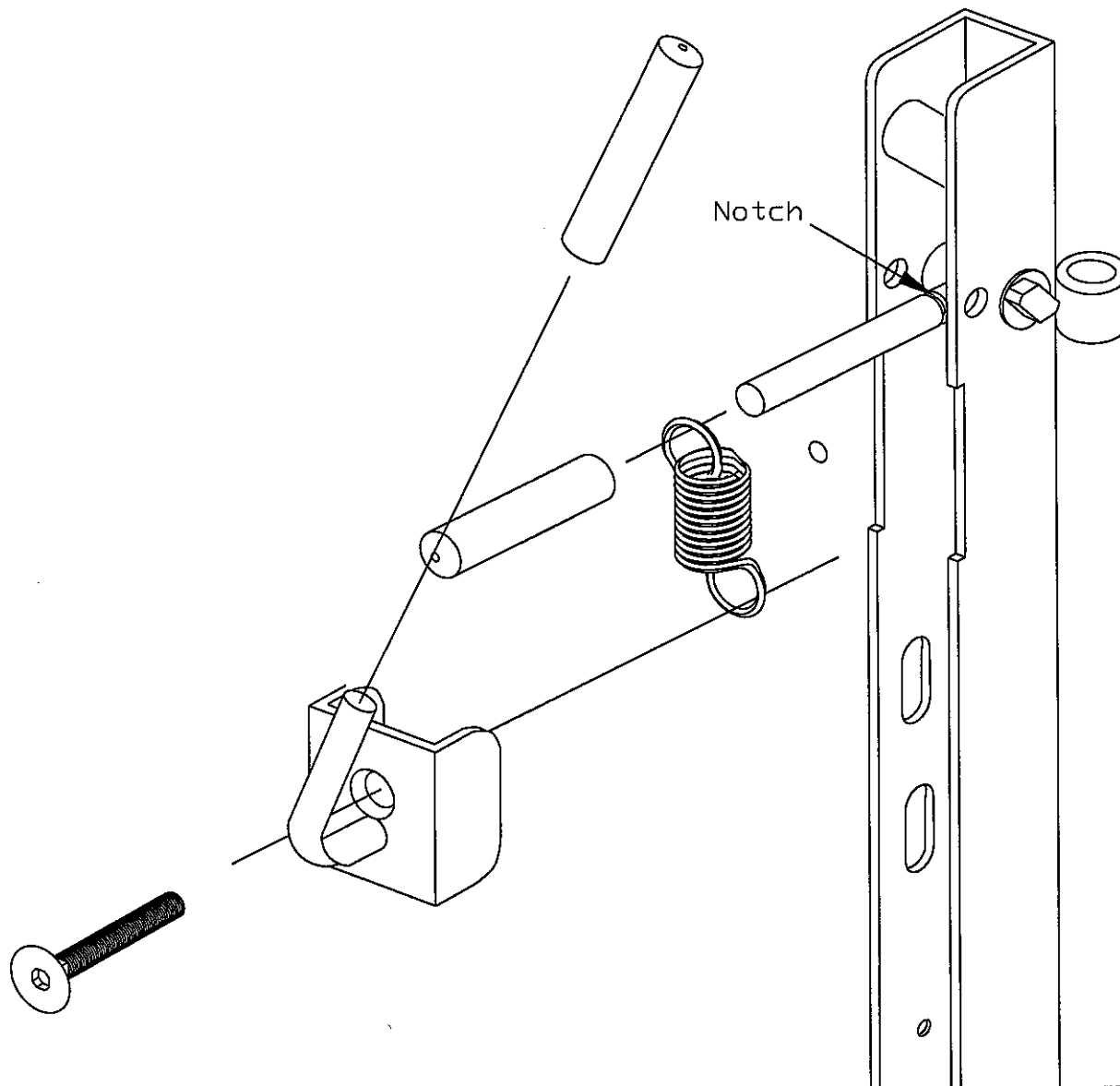

Adjustment

TOOLS REQUIRED: 1/2" socket wrench with extension or 1/2" deep socket.

1. Place the trimmer in the rack by putting the cutting end of the shaft into the hook on the compression pole. Lift the engine end of the trimmer up and into the hook on the locking pole. The trimmer should be positioned so that the handle is resting in the hook on the engine end. Be careful not to damage the throttle trigger when placing the trimmer onto the rack.
2. Assemble the compression pin, 1" hose, and $\frac{3}{8}$ " square washer as shown in the figures below. Attach the compression pin assembly onto the pole using the $\frac{5}{16}$ "-18 x $\frac{5}{8}$ " serrated flange bolt. Slide the pin down until it is touching the trimmer shaft and tighten the bolt.
3. In order for your Trimmer Rack to prevent the trimmer from rotating while in the rack, the compression pins on the compression pole must be adjusted properly. Remove the trimmer from the rack. Use a marker and make a mark on the pin and an aligning mark on the pole as shown in the figure below. Make another mark on the pole $\frac{1}{8}$ " below the first one. Carefully loosen the bolt securing the compression pin and slide the pin down until the mark on the pin lines up with the lower mark on the pole. Tighten the bolt holding the pin securely.
4. Place the trimmer in the rack and test to see that the rack keeps the trimmer from rotating easily. If it does not, re-adjust the compression pin down in $\frac{1}{16}$ " increments until the rack holds the trimmer firmly.
5. Repeat steps 1-4 for the other pins on the pole. NOTE: Since different models of trimmers have different shaft diameters, one position on the rack will need to be adjusted for one model of trimmer and the other positions will need to be adjusted for other models. Unless all of your trimmers are the same or have the same shaft diameters, each trimmer will have to be placed in the rack position which was adjusted to fit that trimmer.

NOTE: The black vinyl sleeves installed over the hooks and bars on your trimmer rack are to prevent your trimmers from getting scratched and worn while in the trimmer rack. These sleeves will wear over time with the use of the trimmer rack and should be replaced annually or as needed.

